

LCR6 S2

Magnetically shielded loudspeaker system

Product Summary

- Quality Home Cinema relies on the seamless integration of sound from loudspeakers that often have different physical sizes and have to be used at different places in the room. The LCR6 S2 is a new model equally suited to left, centre or right positions in a Home Cinema setup.
- The LCR6 S2 is a 2½-way speaker, with magnetic shielding. It has one dedicated Kevlar bass driver, one 6½-inch Kevlar bass/mid range driver and a 1-inch aluminium dome tweeter. Flowport™ technology improves bass definition and prevents chuffing at low frequencies.
- The LCR6 S2 has a Nautilus™ tweeter tube, flat ring tweeter suspension, bullet dust cap and high quality crossover components and with such a high specification it is capable of delivering higher replay levels than many centre or dialogue speakers.

Technical highlights

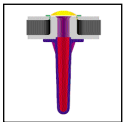

Nautilus™ Tweeter: B&W's Nautilus Tweeter technology ensures that the sound remains focused and time-sensitive and that the stereo-image is presented with unparalleled three dimensional accuracy.



Kevlar®: B&W developed and patented the method of using Kevlar® for loudspeaker cones to reduce unwanted standing waves. DuPont originally created Kevlar® for use in bulletproof vests.

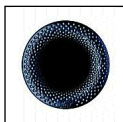

Flowport™: Golf ball aerodynamics theory points the way towards lower distortion reflex ports. Dimples improve the way the air flows over the surface of any object. In the case of reflex ports, they offer a significant improvement over simply flaring the port ends in reducing air flow turbulence at each end of the port; so you get less chuffing noise and less compression at high sound levels.



Description	2½-way vented-box system with magnetic shielding	Sensitivity	89dB spl (2.83V, 1m)
Drive units	1 x 25mm metal dome high-frequency 1 x 165mm woven Kevlar® cone bass/midrange 1 x 165mm woven Kevlar® bass	Nominal impedance	8 (min 6)
Frequency response	58Hz – 20kHz ± 3dB on reference axis	Power handling	25W - 150W into 8 ohm on unclipped programme
		Dimensions	Height: 545mm Width: 204mm Depth: 309mm
		Finishes	Cabinet: Black Ash Vinyl, Cherry Grilles: Black cloth



LISTEN AND YOU'LL SEE